

FAQ for Magicfly

Mini Sewing Machine

CATALOGUE

- 1. Thread**
- 2. Needle**
- 3. Rewinding the thread**
- 4. No power or the machine runs slowly**
- 5. Other problems**

1. Thread

(When the thread of the sewing machine is broken or stuck.)

Turn off and stop the machine.

Check your operation according to the following tips to analyzing and eliminating breakdown.

Causes of Problem	Amendment	
1) The thread is knotted. (common problems)	Untie the knot or cut off the knot and rethread.	
2) Threading operation is not following the manual properly.	Turn the hand-wheel counterclockwise to check if each step of your threading operation is the same as our video.	
3) Thread keeps breaking.	Check the needle: was it bent or not properly seated? If so, remove it and re-insert a new needle.	
4) Stitches too loose or uneven.	Check the tension of the thread: was it too tight? If so, adjust the tension of the thread to the exactly right level as following guide.	

5) Tension-screw is too tight or stitches too loose or uneven.

1. Correct tension of the thread:

Neither too loose (Upper-thread should not piled up), nor too tight (Upper-thread would broke with high probability).

2. How to adjust the tension of the thread to the exactly right level:

- ① Loosen the Tension-screw and put the Upper-thread between two elastic clips.
- ② Tighten the Tension-screw once a bit and try out on a text-cloth to check if the tension level reach your target. Repeat couple times until reach the exactly right tension level.



6) Upper-thread operation through the needle is not FROM LEFT TO RIGHT.

Rethread the Upper-thread through the needle FROM LEFT TO RIGHT.

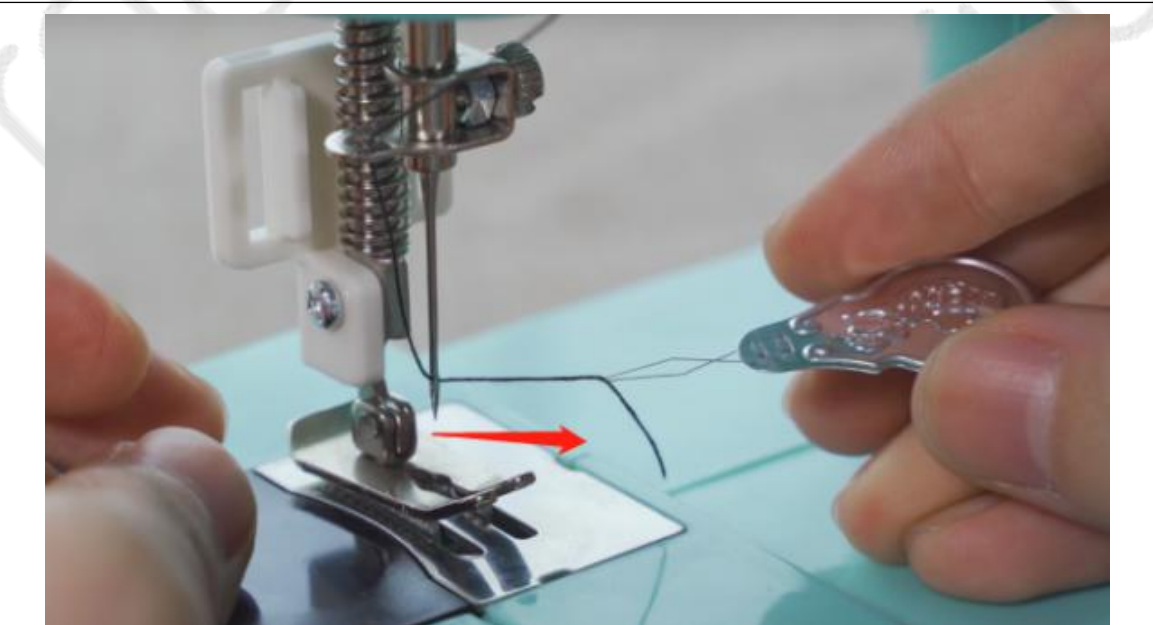

7) Bottom-thread can not be hooked up with Upper-thread.

Bottom-thread should be hooked up according to our video or manual properly.

- ① Check if you turn the Hand-wheel Counterclockwise, NOT clockwise!
- ② Check if the needle is installed **FLAT SIDE TO RIGHT.**
- ③ Check if the thread is stuck.

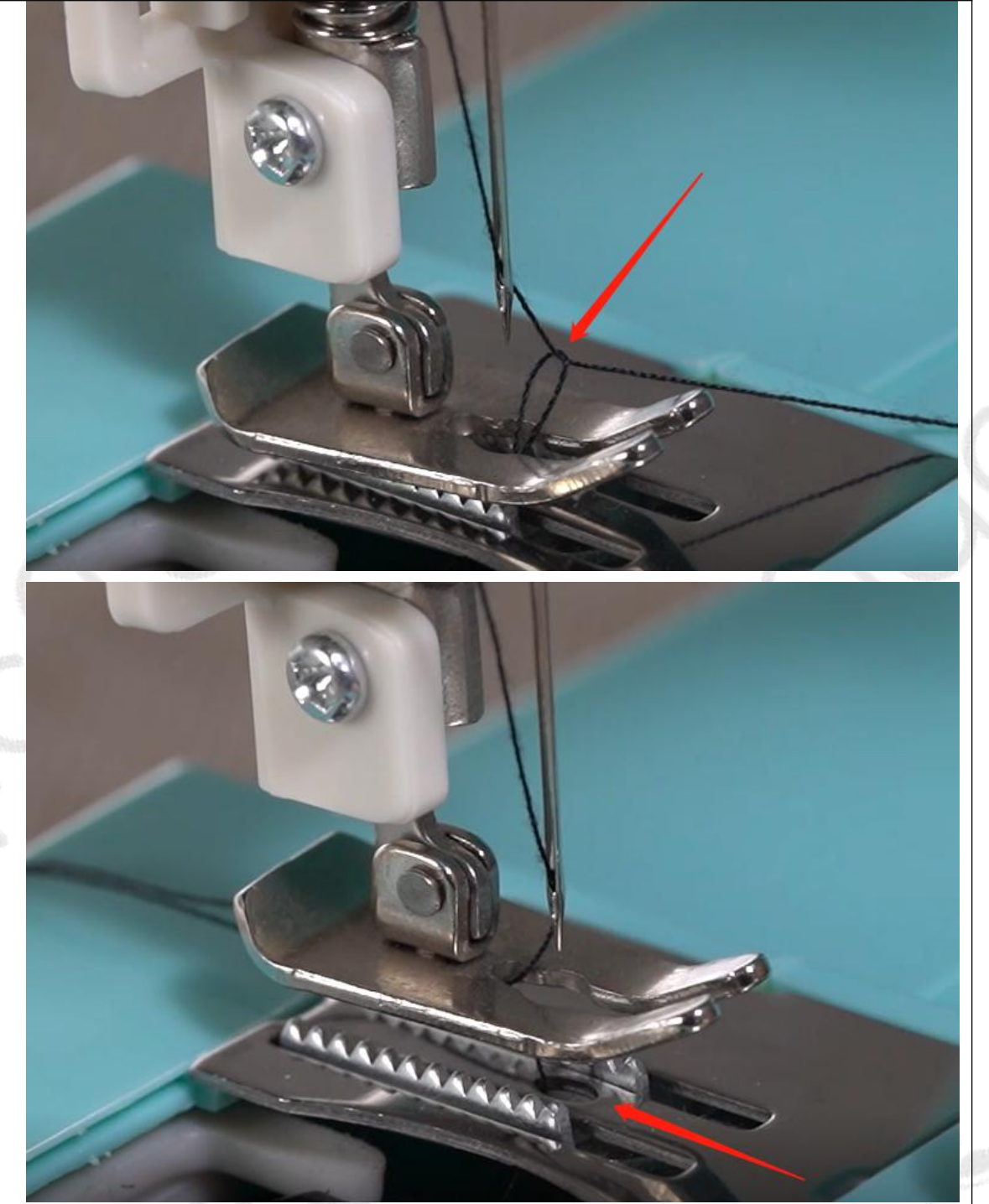

2. Needle

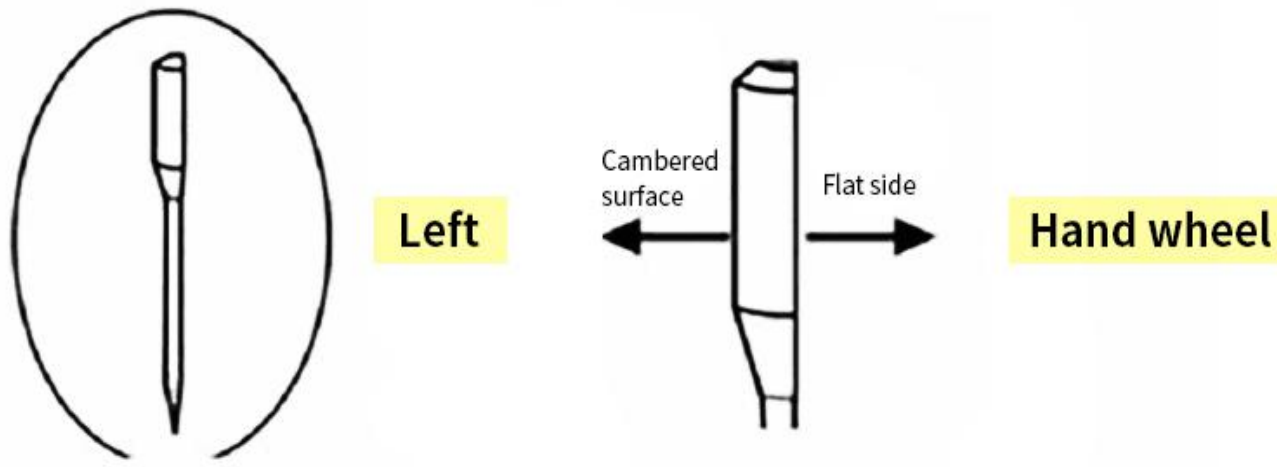
Causes of Problem	Amendment	
1) Needle bent	Remove it and re-insert a new needle.	<p>Face cambered surface of the needle to the left, flat side faces towards hand wheel.</p> 
2) Needle-eye is not in the middle.		
3) Needle is not perpendicular to the horizontal plane		
4) Needle shank not properly seated.		

3. Rewinding the thread

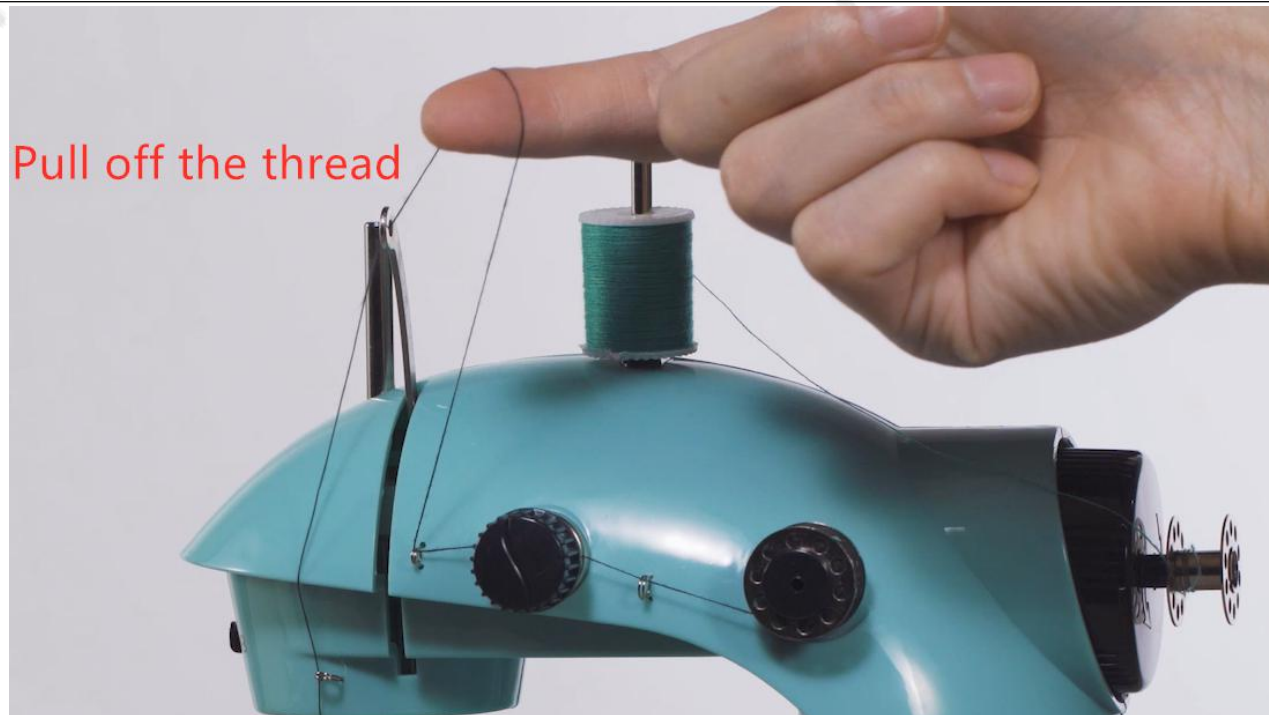
Causes of Problem	Amendment	
Without PULLING OFF THE THREAD before rewinding.	Stop the machine and rethread as video or manual.	

4. No power or the machine runs slowly

Our sewing machine is FCC & ETL & CE & PSE Certified.

Causes of Problem	Amendment	
1) Batteries are installed incorrectly.	Re-install the batteries in the right way.	
2) Batteries are running low.	Change new batteries.	
3) Mismatching voltage or power.	DC/AC 6V 800mA power or 4pc AA batteries.	

5. Other problems

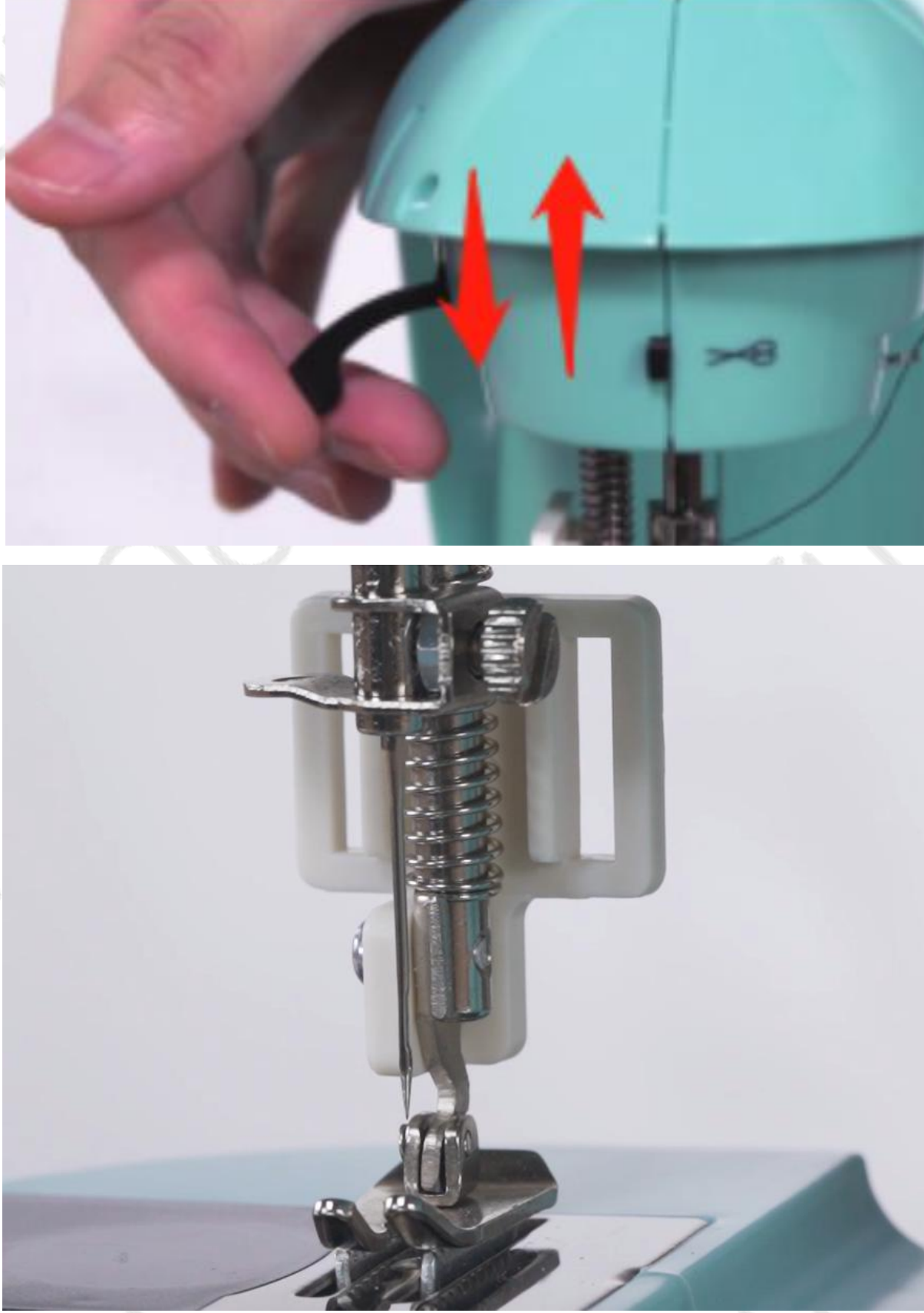
Causes of Problem	Amendment	
<p>1) Check: needle position.</p>	<p>When should LIFT the NEEDLE? Putting in / taking out the cloth , threading and re-inserting a new needle.</p> <p>When should PUT DOWN the NEEDLE? Sewing</p> <p>HAND-WHEEL: Control needle and Bottom-Thread</p>	 <p>Handwheel</p>
<p>2) Check: presser foot position.</p>	<p>When should LIFT the PRESSER FOOT? Putting in / taking out the cloth and threading.</p> <p>When should PUT DOWN the PRESSER FOOT? Sewing and re-inserting a new needle.</p> <p>PRESSER FOOT LEVER: Control the presser foot.</p>	

3) Fabric Thickness.

APPLICABLE CLOTH FOR SEWING

Sewing Presentation Fabric Specification	Cloth				
		Cotton/Linen	Silk/Wool	Polyster	Elastic
Regular		✓	×	✓	△
Thick		✓	×	✓	△
Thin		✓	×	×	×
Hard		✓	✓	✓	△
Soft		×	×	×	×

Sewing effective:

- ✓: means easy to sew
- ×: means difficult to sew
- △: means not smooth to sew

4) All the above steps have been checked and no fault has been found.

Have a question not answered here?
Send us a message.